

Directions

Viewings

Viewings by arrangement only. Call 02033696888 to make an appointment.

EPC Rating

B

Energy Efficiency Rating		Current	Potential
Very energy efficient - lower running costs			
(92 plus) A			
(81-91) B		82	
(69-80) C			
(55-68) D			
(39-54) E			
(21-38) F			
(1-20) G			
Not energy efficient - higher running costs			
England & Wales		EU Directive 2002/91/EC	

Penn Street Mono, N1

Approximate Gross Internal Area 44 sq.m / 474 sq.ft

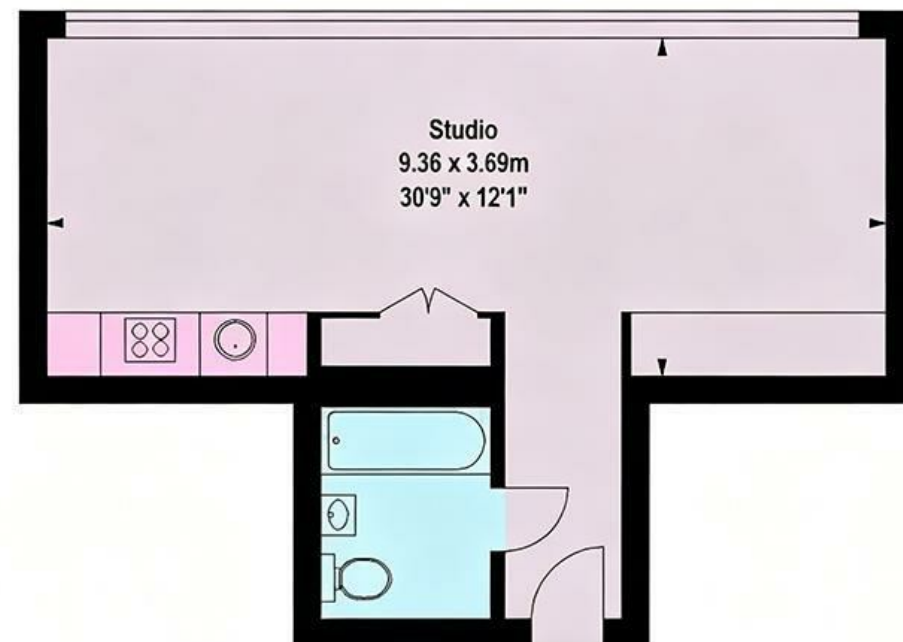

NZ140, Flat 7, Mono Tower Penn Street, London, N1 5FD

£462 Per Week

Mono Tower Penn Street, London N1 5FD

Please quote reference JC25071852 when contacting the officeAvailable from 3rd July***

JCLiving is proud to present this spacious high-spec studio apartment at Mono Tower, Penn Street, London N1.

Mono Tower is one of two iconic hexagonal towers within the prestigious Shoreditch Parkside development. Perfectly positioned between Shoreditch Park and Regent's Canal, the building enjoys a prime setting in the heart of Hoxton, with easy access to Shoreditch's vibrant tech start-ups, independent galleries, cafes and boutiques.

The apartment features generous floor-to-ceiling heights, an open-plan living area with a private balcony, and a fully fitted kitchen with integrated appliances. The bedroom area is equipped with a wardrobe, and a bespoke bathroom completes the layout. Wooden flooring runs throughout.

Transport links are excellent. Hoxton (0.6 miles) and Haggerston (0.5 miles) Overground stations, as well as Old Street Underground (Northern Line, 0.7 miles), are all within easy walking distance. Liverpool Street Station (Elizabeth and Central lines) is just 1.5 miles away.



Council Tax Band:

